

L2G

TECHNICAL SHEET FOR MODEL :

EM-LV35-A1P

REV.00 /24-05-2024

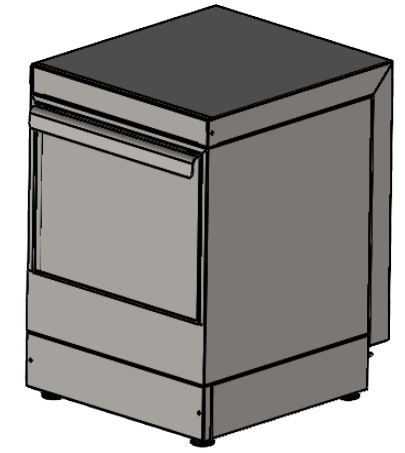
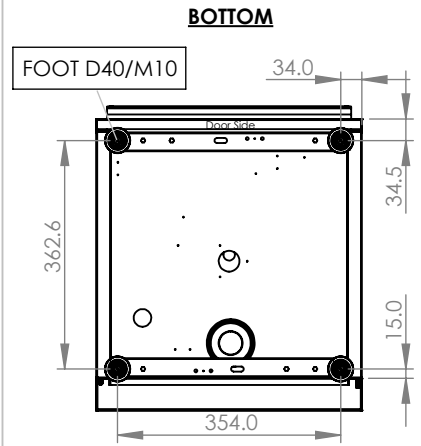
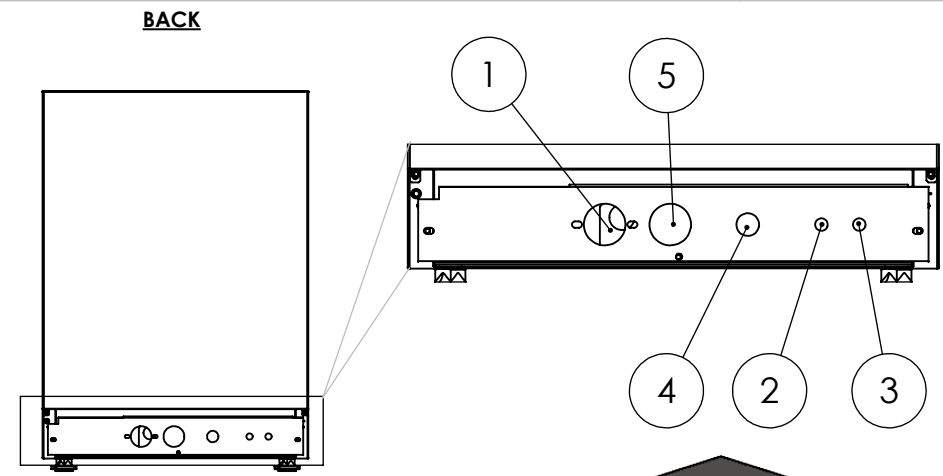
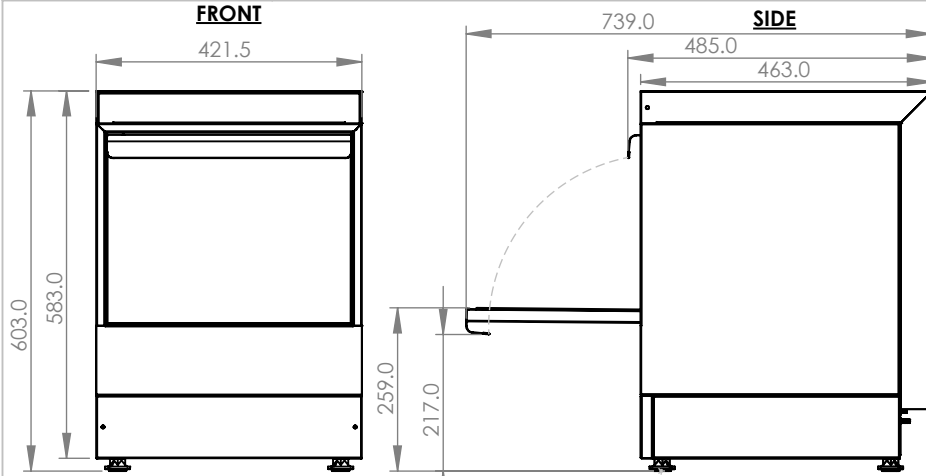

WASHING DATA

Rack Equipment	2 GLASS, 1 CUTLERY
Washing Cycles	1 CYCLE - 120 Sec
Racks/h	30
Noise	59dB
Water Inlet Pressure	2-4 bar / 200-400 Kpa (optimum is 2.5 bar/250 Kpa)
Water Inlet temp. for maximum washing cycles	55 °C
Boiler water temp.	82 °C
Water Inlet equipment (NO1)	Inlet Male Nozzle Threaded End G3/4" f, Pipe L=1.5m
No Drainage Pump Available (NO 5 - Pipe Exit)	Drainage pipe L:1.6m, ID24 - OD 28/34
(NO2)	Rinse Aid Flexible Pipe (Blue), Outer diam. 6mm, L:1.4m
(NO3)	Detergent Flexible Pipe (Clear), Outer diam. 6mm, L:1.4m

MACHINE DIMENSION

WIDTH	421.5mm
HEIGHT	603mm
DEPTH	485mm (With Handle)
WEIGHT	Net 27Kg - Gross 30Kg
Glass Hight Max.	240mm
Rack dimension	350x350mm
Door Clearance	256 mm
Tank capacity	14 Lt
Boiler capacity	2.1 Lt

MACHINE SN SINGLE PHASE (1N)

Voltage	220-240V-1N-50/60Hz
Electrical Supply Connection (NO4)	H05 VV-F 3x2.5mm, L 2.1m Schuko
Maximum Amp.Phase	11.5 A
Maximum Loading	2.6 Kw
Tank Heating Element	2.0 Kw
Tank Water Temp.	60 °C
Pump Power	0.10 Hp / 0.075 Kw
Boiler Heating Element	2.4 Kw